

Standard Grape Crate

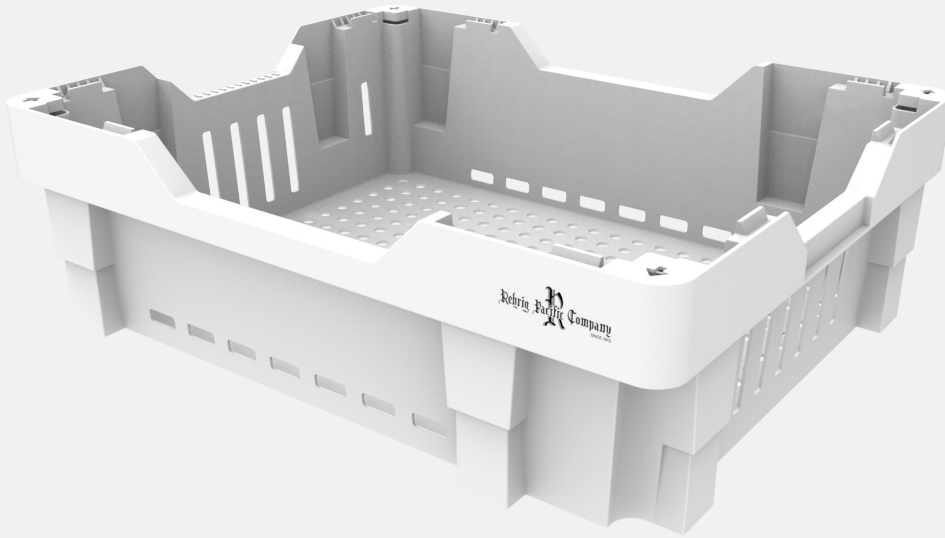

Features & Benefits

- 180° stackable/nestable
- Rugged, durable container
- Optimal venting for efficient cooling
- Fruit friendly, smooth interior
- Plastic design prevents moisture absorption from grapes, stems or atmosphere
- Visual guides for easy stacking and nesting
- Efficiently stacks 6 crates per layer on GMA pallets
- Optional enhanced anti-oxidant package for date fruit
- Hot-stamp branded logos
- Optional 1.5" x 1.5" card slot available on both sides of the short wall for customized labeling
- Tracking technology available in bar code labels or RFID tags
- Material: FDA approved food grade HDPE provides the strength and durability needed for multiple applications
- Color: Available in FDA approved non-heavy metal (NHM) colors. Metal detectable colors are available for compatibility with metal part detection systems
- Decoration: Customer specific decoration available with hot stamp location on the long wall rim

| Specifications | MM/KG | IN/LB |
|------------------------|-------|-------|
| External Length (L) | 508 | 20.0 |
| External Width (W) | 406 | 16.0 |
| External Height (H) | 158 | 6.2 |
| Internal Length | 470 | 18.5 |
| Internal Width | 368 | 14.5 |
| Internal Height | 147 | 5.8 |
| Weight | 0.97 | 2.14 |
| Stack Increment | 53 | 2.1 |
| 53' Truckload Quantity | 8,640 | |

| Decoration Areas | WIDTH (IN) | HEIGHT (IN) |
|----------------------|------------|-------------|
| Long Wall Brand (B1) | 2.0 | 1.0 |

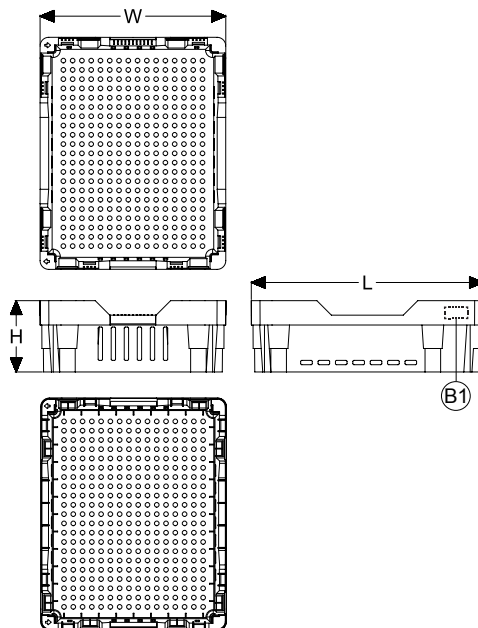

Corporate Headquarters
 4010 East 26th St., Los Angeles, CA 90058
 (800) 421-6244 • (323) 262-5145

Locations
 Los Angeles, CA • Orlando, FL • Atlanta, GA • De Soto, KS
 Erie, PA • Dallas, TX • Kenosha, WI • Quebec, Canada
 Querétaro, Qro., Mexico

Web: www.rehrigpacific.com



A FAMILY TRADITION OF GROWTH, SERVICE AND INNOVATION